

GRB Meeting Room Instructions

Playing a Composite AV Device (DVD, VHS, Wii etc)

1. Turn power to projector by pressing the ON button on wall control. You will hear the projector start up.



2. Select DVD/VHS on wall control.



3. Turn on DVD (Panasonic) and sound (Denon)
4. Lower the screen by pressing the "Screen Down" button on the wall.

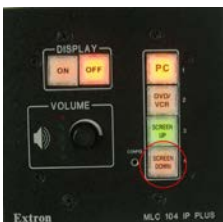

5. Adjust volume by turning volume nob on wall.



6. When finished please reverse order 5 to 1.

Using a laptop

1. Turn power to projector by pressing the ON button on wall control. You will hear the projector start up.



- 2.
3. Connect cables (audio and computer) from laptop to wall plate provided (to the bottom left of projector screen). If you need cables, ask library staff.

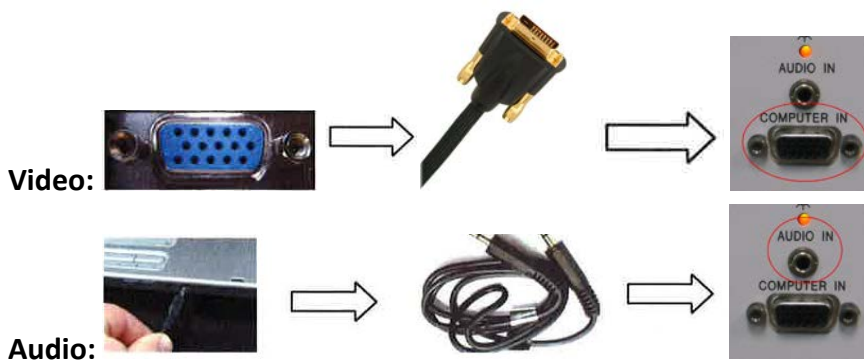

4. Select "PC" on wall control.



5. Lower the screen by pressing the "Screen Down" button on the wall.



6. Adjust volume by turning volume nob on wall.



7. When finished please reverse order 5 to 1.

Notes:

Please do not adjust or disconnect cables (other than laptop) for any reason. Technical support is not guaranteed. Patrons are responsible for their own equipment other than DVD/VHS and wii player.